

Vehicle AHD Front View Camera

Hero-C60S0V42F-2M

V42F is a super mini front view camera, which is designed for commercial vehicles and can applied in various industries, supports wide-angle, anti-fog, vandal-proof and wide voltage functions



Features

- Compact design front view AHD camera, easy for installation by 3M glue double side sticker directly bonded or screwed
- 1/2.9" CMOS, High Resolution: 2MP (1080P)
- Minimum Illumination: 0.1Lux at F1.2,
- Front view lens: 3.6mm (default) / 2.1mm (option)
- 1 pieces 3 meter long extension cable, with 4PIN aviation female connector



Specification

Model	Hero-C60S0V42F-2M
Camera	
Sensor	1/2.9" CMOS sensor
Signal Format	PAL / NTSC
Picture Elements	1920(H)x1080(V)
Horizontal Resolution	2000TVL/1080P(2 Megapixels)
Lens	3.6mm (default)/ 2.1mm (option)
Viewing angle	3.6mm: 90 degree / 2.1 mm (125 degree)
Lens Mount	M12xP0.5mm Thread
Exterior Focus Adjustment	N/A
Synchronization	Internal sync.
S/N Ratio	>44dB(AGC off)
Auto Gain Control	Auto
White Balance	Auto
Electronic Shutter	AUTO/ 1/50 (1/60) -1/100,000sec
Back Light Compensation	Auto
Mirror	No mirror image by default
Gamma Ratio	0.45
Day & Night	Color mode only
Auto-iris Lens Control	N/A

IR (front view camera)	
Infrared LED	N/A
Infrared Spectrum	N/A
Infrared LED Range	N/A
Sensitivity	N/A
Hardware and others	
Video Output	AHD video, 4PIN Aviation female connector
Cable Length	3meter by default, can be extended by extension cable
Audio	support, front view camera: built-in mic
Pan Adjusting	N/A
Tilt Adjusting	Available
Power Supply	12V DC $\pm 10\%$
Power Consumption	110mA $\pm 10\%$
Dimensions(L x W x H)	70.2x38.1x74.7mm
Net Weight	110g
Protection Level	IP65
Operating Temperature	-20°C to +70°C
Storage Temperature	-40°C to +80°C
Humidity	$\leq 85\%RH$

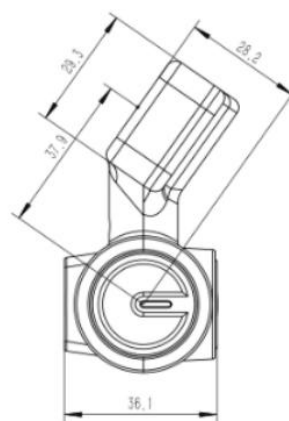
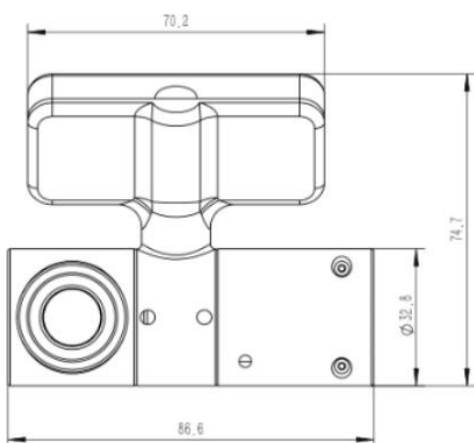
Dimension (unit: mm)



+12V 1  4 Video
 GND 2  3 Audio
 4PIN Aviation interface -Female

Appearance

